

care of  
the reel!

The Holliday is a fine precision mechanism. A little attention in keeping it clean and properly lubricated will be repaid by years of dependable service.

Bearings in the Holliday, the axle and gear shank as well as the pinion bearing should require cleaning and oiling only once a year with normal use.

NOTE: After using in brackish or salt water, wash the reel in fresh water immediately; then oil all exposed moving parts. Materials and finish have been chosen to make this reel as corrosion resistant as possible and still retain the lightness and strength required in this type reel. Repair parts are available at leading sporting goods and tackle stores. If you cannot find a dealer handling the parts, they may be purchased directly from the home office. It is recommended that, whenever possible, reels needing repairs or general overhauling should be returned to the home office at E. TAUNTON, MASS.

NOTE: Please remove fishing line before returning reel.

### SPECIAL EXTENDED CAST FEATURE

The No. 60 HOLLIDAY is unique in that it has the "Special Extended Cast" feature. When the reel is in casting position and the line is picked up, the angler pulls out, or pulls forward on the spool. The spool then extends completely so that the LINE CARRYING portion of the spool is free of the flyer. Then when the cast is made there is no "line-slap" or friction to slow the cast. Result — longer and more effortless casts! When starting to retrieve, the spool automatically engages and MAGIC PICK-UP takes over.



### pick up "gap" adjustment

If your reel should fail to pick up properly, or if it should bind when using exceedingly heavy line, it may become necessary to adjust the gap between the spool flange and the flyer. To do this turn the knurled ring just behind the flyer. If the reel is binding and the MAGIC FLYER is touching the spool, turn the knurled ring counter-clockwise (looking at the reel from the rear). If the MAGIC FLYER is failing to pick up the line, turn the adjusting ring clockwise. Only a minimum of adjustment is needed. Try it a little at a time.

### OILING INSTRUCTIONS

Remove the crank screw marked OIL and, using a tube of reel or gun grease, squeeze a generous amount into the hollow crank shaft. This will lubricate the gears, cam, cam pin, etc. Externally, a few drops of machine oil should be applied to the anti-reverse knob and crank knob every few days when using the reel continuously. The spool should also be removed occasionally and the shaft and friction washers oiled. Be sure that a few drops of oil reach the shaft behind the friction plate.

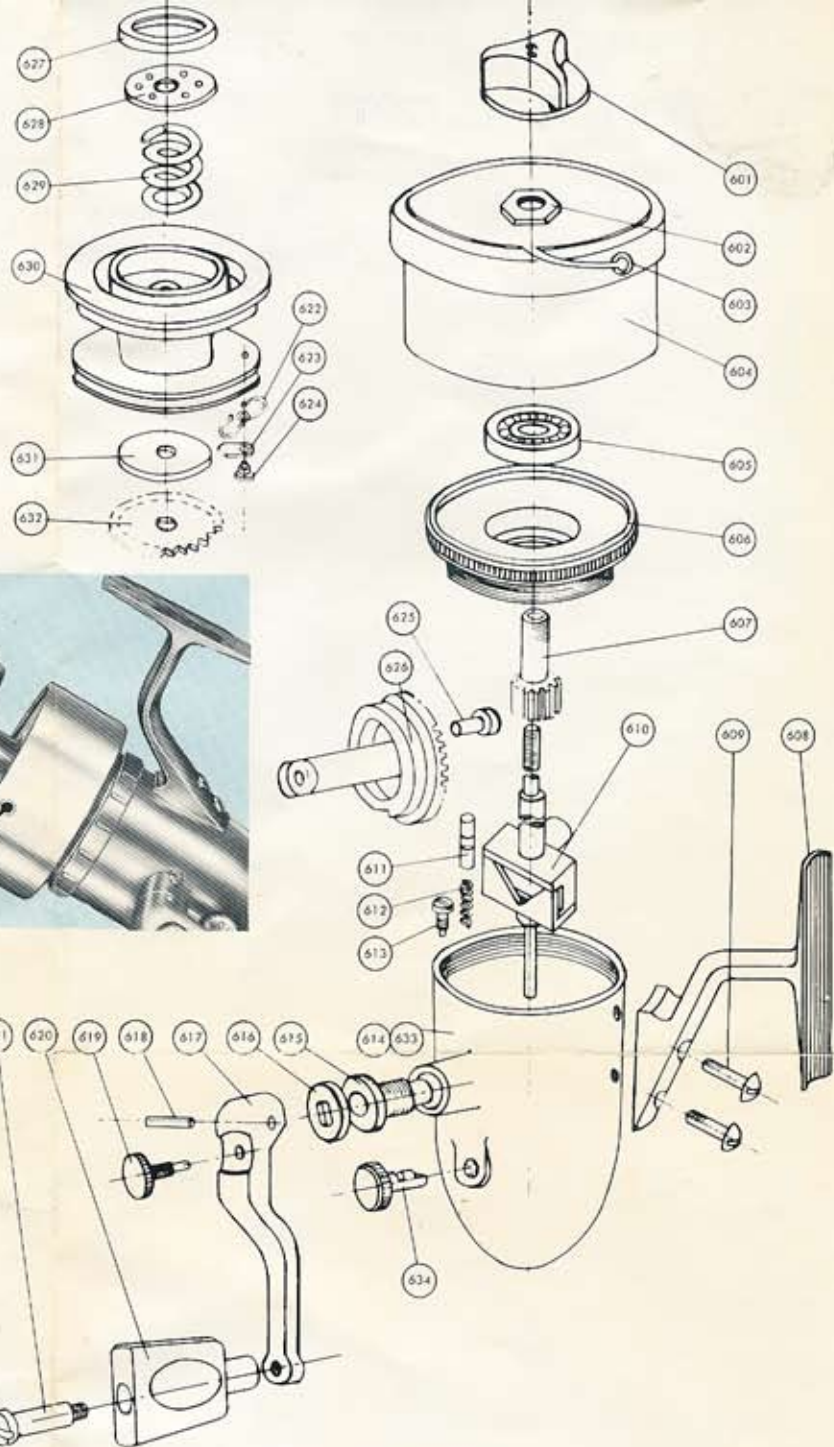

### REPAIR PARTS

Part No.	Part Name	Part No.	Part Name	Part No.	Part Name
601	Drag Knob	618	Crank Pin	628	Drag Plate
602	Pinion Nut	619	Crank Screw	629	Drag Spring
603	Line Guide	620	Crank Knob	630	Spool Body
604	Rotating Head	621	Knob Screw	631	Friction Washer
605	Ball Bearing	622	Drag Click Spring	632	Friction Plate
606	Bearing Retainer	623	Drag Click Pawl	633	See No. 614
607	Pinion	624	Drag Click Screw	634	Anti Reverse Knob
608	Stand	625	Cam Pin	635	Extra Spool Complete
609	Stand Screws	626	Gear	636	Rotating Head with Carboly Ring
610	Axle Shaft	627	Drag Ring		
611	Anti Reverse Plunger				
612	Anti Reverse Spring				
613	Anti Reverse Screw				
614	Body and Bushing				
615	Crank Bushing				
616	Crank Washer				
617	Crank				

Reels being returned for repair or service must be shipped PREPAID to:

**Holliday Reel Co.**

Division of FAB-RIK-O-NA, INC.

103 Old Colony Ave., East Taunton, Mass.