

More Fishing Pleasure

WITH YOUR **ORVIS** SPINNING REEL

ENGINEERED FOR EXTRA YEARS OF SERVICE AND ENJOYMENT
Rated 1st Choice by Fishing Guides and Champions

YOUR NEW MODEL **ORVIS 200** REEL

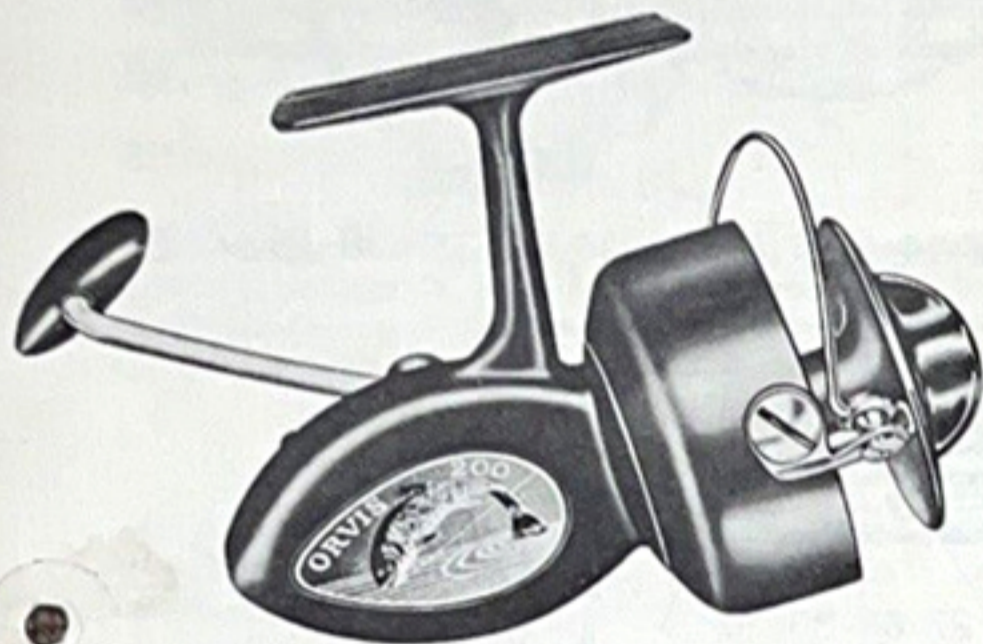

ORVIS 200 right hand model.....\$39.50
Additional Spools\$ 4.00

For minor repairs when fishing, have on hand the Field Repair Kit. \$3.25 Specify Orvis 200 Reel.

for salt water and surf AND ALL HEAVY DUTY SPINNING WITH THESE GREAT FEATURES

- ▶ **Corrosion Protection** — Housing cover, rotating case, spool and other aluminum parts are all anodized for protection against salt water.
- ▶ **Stainless Steel pick-up assembly.**
- ▶ **Collapsible Handle** — makes reel more compact and easier to carry.
- ▶ **Superior Gear Construction** — specially designed to eliminate axial thrust; the pinion gear is made from alloy heat treated steel and supported by a ball bearing.
- ▶ The main gear is made from hardened steel alloy and supported by self-lubricating sinterized bushings.

- ▶ **New Smooth-Set Drag** — strong coil spring clutch is built into clutch knob.
- ▶ **Two Bail Springs** insure quick positive closing.
- ▶ **Rotating Case Brake** — case won't turn while you cast.

BIG CAPACITY:

560 yds. 8 lb. test	340 yds. 11½ lb. test
430 yds. 9½ lb. test	250 yds. 14 lb. test

WATER QUEEN LINE

FAST RETRIEVE: 3.83 to 1

TO TAKE IT — The one reel built to stand the punishment of surf and ocean fishing, and take the pressure of heavy lines and big fish. Weighs 18 oz.

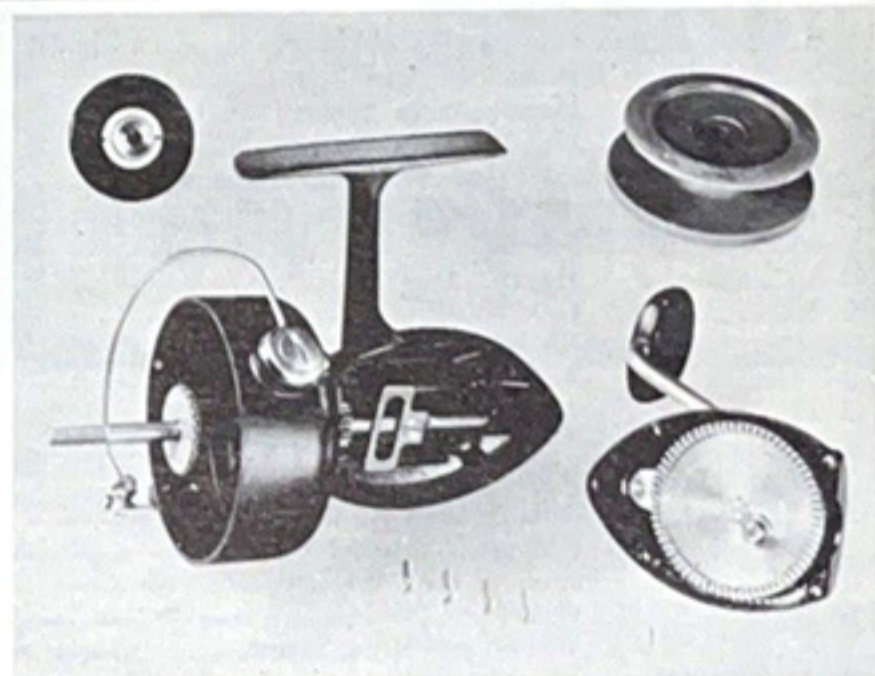

Reel is easily taken apart for cleaning and lubrication. Note simplicity of design and few moving parts.

CHARLES F. ORVIS

CO. / *Manchester, Vermont*

ORVIS 200 SPINNING REEL

PARTS LIST

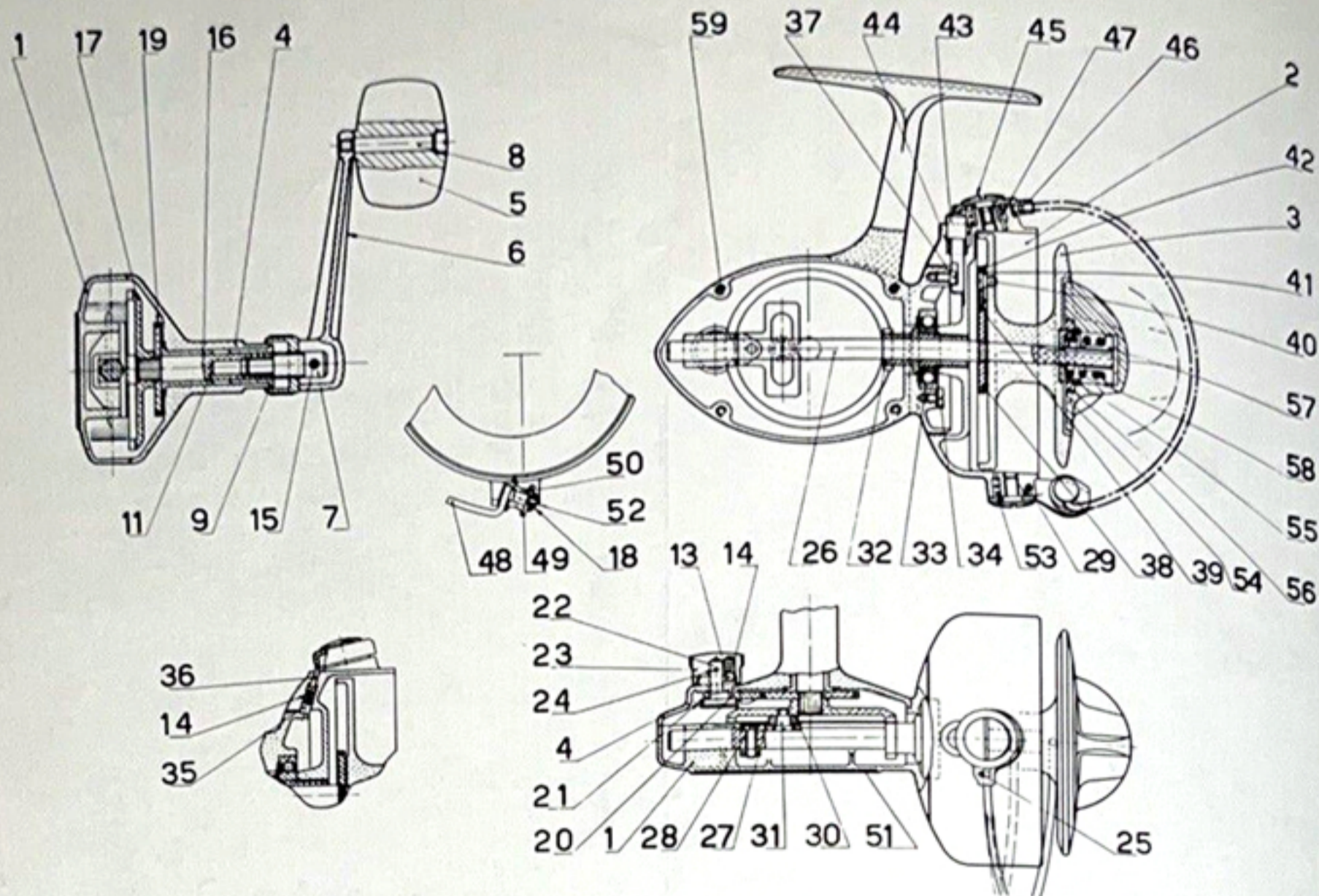

Part No.	Description	Price	Part No.	Description	Price
2-1-51	Reel Case	\$6.65	2-32	Pinion Gear	
2-2	Rotating Case	5.75	2-33	Ball Bearing	\$1.85
2-3	Spool (complete)	4.00	2-34	Ball Bearing Retaining Screw	4.50
2-4	Reel Cover	3.85	2-35	Brake Shoe	.10
2-5	Handle Grip	.65	2-36	Brake Acting Pin	.10
2-6	Handle	1.75	2-37	Acting Pin	.10
2-7	Handle Screw	.85	2-39	Fibre Washer	.10
2-8	Handle Grip Screw	.30	2-40	Spool Click Screw	.15
2-9	Handle Retainer	.90	2-41	Spool Click Spring	.10
2-11-17-19	Gear Assembly	5.85	2-42	Spool Click	.10
2-13	Anti-reverse Knob Ball	.02	2-43	Cam Stop Plunger	.55
2-14	Spring	.04	2-44	Stop Plunger Spring	.75
2-15	Handle Pin	.10	2-45	Cam Screw	.11
2-16	Gear Bushing	.45	2-46	Pickup Cam	.35
2-18	Roller Nut	.25	2-47	Cam Spring	1.55
2-20	Anti-reverse Click	.35	2-48	Pickup Bail Wire	.15
2-21	Anti-reverse Spring	.15	2-49	Roller Housing	1.30
2-22	Anti-reverse Eccentric Pin	.60	2-50	Roller	1.90
2-23	Anti-reverse Knob	.75	2-51	Trade Mark Plate	.60
2-24	Anti-reverse Knob Pin	.10	2-52	Roller Screw	.65
2-25	Pickup Retaining Pin	.10	2-53	Roller Housing Spring	.45
2-26-38	Stem & Saw Washer	1.70	2-54	Clutch Knob (without parts)	.15
2-27	Operating Slide	.65	2-55	Clutch Washer	.75
2-28	Operating Slide Screw	.20	2-56	Clutch Ring Nut	.65
2-29	Rubber Stop	.05	2-57	Clutch Nut	.25
2-30	Stem Acting Roller	.35	2-58	Clutch Spring	.30
2-31	Acting Roller Screw	.35	2-59	Cover Screw	.18

PARTS ASSEMBLIES

2-5-6-7-8-9-15	Handle Assembly	\$4.40	2-25-46-48-52	Pickup Bail Assembly	\$3.40
			2-54-55-56-57-58	Clutch Knob Assembly	2.15

Operating and Maintenance Instructions

ORVIS 200 REEL

Spool Drag

The spool drag is accomplished by the clutch knob in front of the spool. Turn the knob clockwise to increase drag. To remove the spool, first remove the clutch knob by turning counterclockwise.

Anti-reverse

The anti-reverse click is operated by the round knob conveniently located where it can be reached without letting go of the handle. A half turn of the knob will put the click "on" or "off".

Collapsible Handle

For convenience in packing and carrying, the Handle Assembly is hinged, and can be collapsed by loosening the knurled Handle Retainer by turning it clockwise. The Handle Assembly can also be removed by winding it in reverse direction.

Care and Maintenance

After each use in salt water, wipe off your Orvis 200 with a damp cloth and then dry thoroughly. Be sure and clean out behind the spool. Then carefully oil all moving parts.

Remove cover screws and open the reel housing periodically, so that you can clean the interior moving parts. Replace the lubricants using light grease on the gears and spool shaft. Use light oil on these parts in cold weather.

Servicing the Pickup Assembly

Should it be necessary to dismantle the pickup assembly to replace worn parts such as roller, operating springs, etc., always disconnect the bail wire at the roller end first. This will allow the bail to swing free and make the following steps easier.

To replace the spring under the roller arm, remove the roller arm screw, insert new spring with one tip of it going in the small hole in the bottom of the spring socket and the other tip in the small hole in the roller arm. Hold roller arm down in position with thumb and forefinger and replace the screw.

To replace the parts under the cam end of the pickup, remove the cam screw. To reassemble first replace the plunger and plunger spring. Then replace the operating spring with its tips connected in the small holes in the socket and cam, hold cam in place with the plunger lined up in the plunger slot in the cam and replace the cam screw. To put tension on the operating spring, depress the plunger and rotate the cam counterclockwise until the plunger clicks up. Reconnect the bail at the roller arm.

Dismantling the Reel

All major parts of the Orvis 200 can be removed easily. Be sure to use only the correct size screw drivers on all screws; otherwise the heads may become damaged.

To remove the main gear, set the anti-reverse on and crank the handle backwards. The main gear and shaft will come free when the handle is off.

To remove the spool shaft, take out the screw in the operating slide and pull the shaft out.

To remove the rotating case, first take out the spool shaft, then insert a small rod through the holes in the side of the pinion gear to provide leverage and unscrew the rotating case clockwise — it has a right hand thread.



Lubriplate is recommended for use as a heavy lubricant for the gears of any spinning reel, and is especially desirable for salt water fishing for it protects the steel parts against corrosion.

Price . . . 50¢



The Valvespout Oiler is a very handy article for applying light oil to those small hard to reach parts. Solid brass, chrome plated, leak-proof. Twist valve for closing and opening. Capacity 1/2 fl. oz.

Price . . . \$1.25



Art. 100-Long Spoon
No. 1 1/4 oz. 65c ea.
No. 3 3/8 oz. 90c ea.



Art. 102-Colored Spinner
No. 2 1/4 oz. \$1.15 ea.
No. 4 3/4 oz. \$1.35 ea.



Art. 46-Pearl Copper Spoon
No. 2 1/2 oz. \$1.45 ea.
No. 3 1/4 oz. \$1.75 ea.
No. 4 3/8 oz. \$2.15 ea.

Art. 104-Flat Spinner
No. 1 1/2 oz. 80c ea.
No. 2 1/4 oz. 85c ea.



Art. 106-Normal Spoon
No. 1 1/4 oz. 65c ea.
No. 3 3/8 oz. 80c ea.



Art. 108-Pike Special
No. 1a 1/4 oz. \$1.05 ea.
No. 1 3/8 oz. \$1.05 ea.
No. 2 3/4 oz. \$1.20 ea.

